



**Wandsworth
Professional
Development
Centre**



Smart space, for
smart thinking people.





SMART SPACE /

Wandsworth Professional Development Centre (WPDC)

Built in 2012, WPDC is a fresh, smart, environment for professional learning in Wandsworth. The purpose-built centre combines contemporary architecture with flexible room spaces, making it the smart choice for professional development events and meetings. The operations team assist with every event, offering support to trainers and welcoming all visitors.

As part of Wandsworth Council, WPDC delivers a high quality, customer focussed service.

Housed on the top floor of Burntwood School, designed by architects Allford Hall Monaghan Morris, the building has won numerous design awards. WPDC is full of light with wide windows in every room offering panoramic views across the Wandsworth skyline.

WiFi is available throughout, with projectors, multi-media screens and flexible table arrangements. Refreshments are served in a large open plan lounge where delegates can network and additional refreshments can be purchased by delegates at the on-site café.

Located in Wandsworth, the centre has excellent transport links and is just a short walk from Earlsfield Station and local bus routes (see back cover). In addition there is a small on-site car park & bicycle rack for visitors.

“In terms of how meetings run – strategically – what is of huge benefit is that it is uncluttered and contemporary. A physical space that allows for thinking space.”

Mark Holliday

Welcome to
WANDSWORTH
PROFESSIONAL
DEVELOPMENT
CENTRE



Open plan, breakout lounge that is available for delegates to use throughout the day. The space provides a relaxed, comfortable environment for refreshment breaks, lunches and the opportunity to network.



Sarah Anderson

SMART SPACE /

Adapting to your business requirements

Specifications /

Capacity: Up to 120 people when hired with Battersea
 Style: Open plan
 Size: 8.5m x 10m

Seating styles /

This area can be booked with Battersea Room to create a space for up to 120 people, depending on the layout required. Please contact the team at WPDC to discuss options.

Features with Battersea /

Wireless internet
 Multimedia projector
 Large projection screen
 Laptop
 Audio speakers
 Wireless pointer
 Wireless microphones
 Flipchart stand and pens

Benefits at-a-glance /

- ▶ Flexible, open-plan layout
- ▶ Comfortable seating
- ▶ Refreshments and lunches on request
- ▶ Natural daylight
- ▶ Wifi throughout

Cater the space /

On-site catering facilities offer tasty options, from sandwiches to canapés and buffet style menus.

SMART PEOPLE /

Sarah Anderson

Governor Services Clerk
 Smart School Services
 Wandsworth Borough Council

Why WPDC?

For head teachers to come out of a school environment (eg, for conferences, pupil referrals, etc) and into a neutral meeting room can make a big difference.

What was it like?

Of all the meeting rooms across all the councils it's the very best to go to. It's always clean, the toilets are pristine and everybody is so helpful. They are more than willing to set rooms up ahead of the meeting and help with IT, even for people who haven't a Scooby-Doo about what they are doing. And if you need something printed out you know that the printer has got paper in it. It's set out like a work meeting space and run along those principles. The ladies are super helpful and professional and always willing to help out. That's why I like it, you don't feel like you are on your own.

Book Wandsworth /

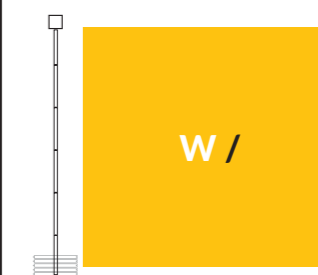

Contact our dedicated team of event experts today, for availability, rates and viewing appointments.

Bookings and enquiries:
 e / wpdc@wandsworth.gov.uk
 t / 020 8871 8775



Large space, equipped with an expansive projection screen. Flexible and adaptable, to accommodate a variety of room layouts.



SMART SPACE /

Where flexibility meets function

Specifications /

Capacity: Up to 30 people
Style: Flexible
Size: 7.5m x 7.6m

Seating styles /

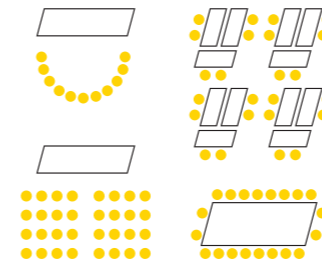

Features /

- Wireless internet
- Multimedia projector
- Large projection screen
- Laptop
- Audio speakers
- Wireless pointer
- Wireless microphones
- Flipchart stand and pens

Benefits at-a-glance /

- ▶ Natural daylight
- ▶ Flexible room layout
- ▶ Projector and large screen
- ▶ Brilliant acoustics
- ▶ Comfortable seating

Expand the space /

Opening Battersea room's dividing wall with Wandsworth breakout lounge, offers the option of creating a larger open-plan space ideal for networking events and conferences.



Florence Clark

SMART PEOPLE /

Florence Clark

Workforce Development Manager
Wandsworth Children's Social Care Academy
Wandsworth Borough Council

Why WPDC?

It's a really nice, big bright space so it feels like a bit of a treat to go there, tucked away in the borough. The front desk staff are on hand to help with IT support, microphones, PowerPoint etc. We have meeting rooms in our building, but you couldn't get any support if equipment wasn't working, and the tables/chairs are not laid out.

What was it like?

They're not there to just check you in. We had an event in January which ended up with 70 (not the expected 40) and the WPDC staff bought extra sandwiches and cakes so we could cater for everyone. They'll also liaise directly with the trainers that we commission to arrange the room, looking at different options for communal areas and break out space. I find if you need a room, and they are all booked up, they will often liaise to fit you in. If we want to order lunch they take care of that.

Book Battersea /

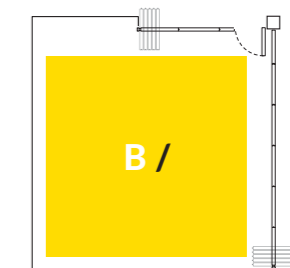

Contact our dedicated team of event experts today, for availability, rates and viewing appointments.

Bookings and enquiries:
e / wpdc@wandsworth.gov.uk
t / 020 8871 8775

Expansive, open plan room – an excellent space for larger training sessions. Perfectly sized on its own; however, when combined with the Balham Room, the space can accommodate up to 100 people.



SMART SPACE /
The trainer's choice

Specifications /

Capacity: Up to 40 people
 Style: Flexible
 Size: 8.5m x 9.2m

Seating styles /

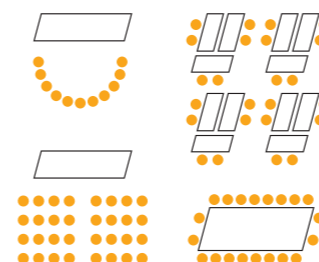

Features /

Wireless internet
 Multimedia projector
 Large projection screen
 Laptop
 Audio speakers
 Wireless pointer
 Wireless microphones
 Flipchart stand and pens

Benefits at-a-glance /

- ▶ Natural daylight
- ▶ Flexible room layout
- ▶ Projector and large screen
- ▶ Brilliant acoustics
- ▶ Comfortable seating
- ▶ Wall flipchart paper holder

Expand the space /

Tooting and Balham can be hired together to create a 8.5m x 14m space for up to 100 people. Ideal for conferences or large training events.



Elizabeth Souter

SMART PEOPLE /
Elizabeth Souter

Wandsworth's Head of Service for Children Looked After and Care Leavers
 Wandsworth Borough Council

Why WPDC?

We use it a lot for training. It allows 80-100 of us to come together for a service morning, thinking and talking about the work we do and to be the best we can be. Some of my staff are based at the town hall, and also satellite offices, so they don't see each other often. Our work is all linked and related, so knowing what each other is doing is important.

What was it like?

We use the space to think and build morale. Since the pandemic, spending time together doesn't happen that often. It might sound like simple things, but having a space that is modern and clean, where everything works and people are on hand to help you set up is really important. WPDC helps people focus on why they are there because the environment is conducive to concentration and comfort – the things you need to not be distracted.

Book Tooting /

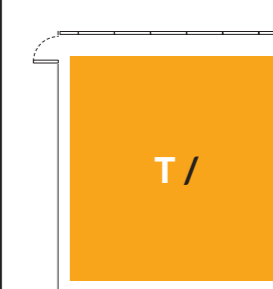

Contact our dedicated team of event experts today, for availability, rates and viewing appointments.

Bookings and enquiries:
 e / wpdc@wandsworth.gov.uk
 t / 020 8871 8775



A compact space with a warm, focused feel, ideal for smaller events and meetings. Flexible in its layout, tables and chairs can be easily moved or arranged, based on an agreed layout. When combined with the Tooting Room, the space can accommodate up to 100 people.



SMART SPACE /

Designed to motivate

Specifications /

Capacity: Up to 16 people
Style: Flexible
Size: 8.5m x 4.8m

Seating styles /

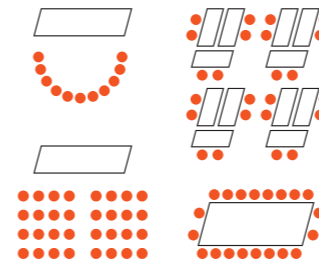

Features /

Wireless internet
Multimedia projector
Laptop
Interactive screen
Audio speakers
Flipchart stand and pens
Wireless pointer

Benefits at-a-glance /

- ▶ Natural daylight
- ▶ Flexible room layout
- ▶ Projector and interactive screen
- ▶ Brilliant acoustics
- ▶ Comfortable seating

Expand the space /

Balham and Tooting can be hired together to create a 8.5m x 14m space for up to 100 people. Ideal for conferences or large training events.



Michele Beute

SMART PEOPLE /

Michele Beute

Mediator and Trainer
LH Mediation

Why WPDC?

Wandsworth Professional Development Centre was booked by the council who use it for various forms of training.

What was it like?

I was unfamiliar with their IT set up – something as simple as switching from one laptop to another – but the staff calmly step in to show you what to do. I've worked in places where you have flip-over tables and you see trainees distracted, dropping things on floor, but here there are larger tables. In training you have different room set-ups and at WPDC they are willing to facilitate any design: that makes life incredibly easy. As a trainer you don't go in and fret because they ask you beforehand (with a needs analysis) about how many flip charts you need and where you want tables and chairs... Lorna's the face of the centre, but all the WPDC staff were so keen to meet the needs of both trainers and participants.

Book Balham /

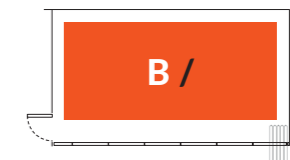

Contact our dedicated team of event experts today, for availability, rates and viewing appointments.

Bookings and enquiries:
e / wpdc@wandsworth.gov.uk
t / 020 8871 8775

A bright spacious room which is flexible in its layout. Tables and chairs can be easily moved or arranged, based on an agreed layout. This room interlinks with Roehampton room. When both rooms are hired together they can accommodate up to 70 people.



SMART SPACE /

Enhancing the learning experience

Specifications /

Capacity: Up to 24 people
 Style: Flexible
 Size: 6.5m x 7.8m

Seating styles /

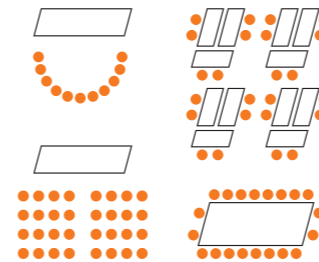

Features /

- Wireless internet
- Multimedia projector
- Laptop
- Interactive whiteboard
- Audio speakers
- Wireless pointer
- Flipchart stand and pens

Benefits at-a-glance /

- ▶ Natural daylight
- ▶ Flexible room layout
- ▶ Projector and portable screen
- ▶ Brilliant acoustics
- ▶ Comfortable seating

Expand the space /

Putney and Roehampton can be hired together to create a 6.5m x 14m space for up to 70 people. Ideal for training or large meetings.



Lizzie Haynes

SMART PEOPLE /

Lizzie Haynes

Mediator and Trainer
 LH Mediation

Why WPDC?

We do a lot of work with Richmond and Wandsworth council. The council asked Wandsworth Mediation Service if they'd deliver work on reducing parental conflict to the teams who deal with parents and children.

What was it like?

It's a very calm, modern space. We used the Putney room for nine training courses. It has all the technical stuff you need – multi-media projector, laptops and large projection screens, plus flip charts and pens. For a trainer, you can simply attach your computer and start your PowerPoint slides. The rooms are spacious with great windows and a fantastic views of trees. Staff are accommodating to any of your needs or any questions. Break out spaces in the lounge are lovely with a desk to plug in your own computer to do work pre or post course. It's very congenial – we ordered in tea, biscuits and filtered coffee. There's also a water dispenser.

Book Putney /

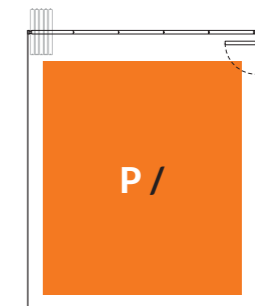

Contact our dedicated team of event experts today, for availability, rates and viewing appointments.

Bookings and enquiries:
 e / wpdc@wandsworth.gov.uk
 t / 020 8871 8775



A double aspect room with large windows, offering a bright space with flexible layouts that can be adapted to a range of focused training or meeting requirements. A bird's eye view of the treetops through the windows of the room enhance the relaxed and comfortable feel of the space.



SMART SPACE / A room with a view

Specifications /

Capacity: Up to 16 people
Style: Flexible
Size: 6.5m x 6.2m

Seating styles /

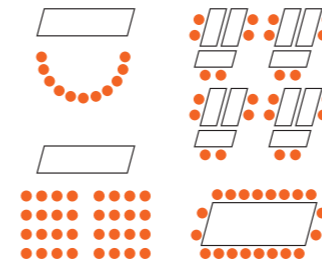

Features /

Wireless internet
Laptop
Interactive touch screen
plus integrated speakers
Flipchart stand and pens
Wireless pointer

Benefits at-a-glance /

- ▶ Natural daylight
- ▶ Flexible room layout
- ▶ Projector and portable screen
- ▶ Brilliant acoustics
- ▶ Comfortable seating

Expand the space /

Roehampton and Putney can be hired together to create a 6.5m x 14m space for up to 70 people. Ideal for training or large meetings.



Mark Holliday

SMART PEOPLE / Mark Holliday

Deputy Head of Education
Inclusion and Participation
Wandsworth Children's Services

Why WPDC?

I use it for more important training/CPD-type meetings, and also for events, because the building is so well-maintained, contemporary, clean and tidy, and the front of house staff are amazingly helpful and friendly. The options for layout of the room and the flexibility is really helpful. Before a meeting, or event, the rooms are always well laid out, and there's always someone to help you with the IT if you need support setting up a presentation. When holding important meetings and events you need that reassurance.

What was it like?

It is tucked away, which makes it a nice, serene environment which lends itself well to learning, being based on a school site. It's not so far from Earlsfield train station, and bus routes run directly past. In terms of how meetings run – strategically – what is of huge benefit is that it is uncluttered and contemporary. A physical space that allows for thinking space.

Book Roehampton /

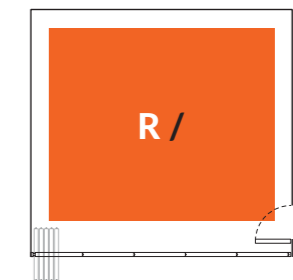

Contact our dedicated team of event experts today, for availability, rates and viewing appointments.

Bookings and enquiries:
e / wpdc@wandsworth.gov.uk
t / 020 8871 8775

Large, self-contained space, offering a flexible, uplifting space. Ideal for meetings and training in a business environment. The room is brightly lit by a wall of windows, which provides a panoramic view across the Wandsworth skyline.



SMART SPACE /
Professionalism at its best

Specifications /

Capacity: Up to 16 people
 Style: Flexible
 Size: 6m x 7.7m

Seating styles /

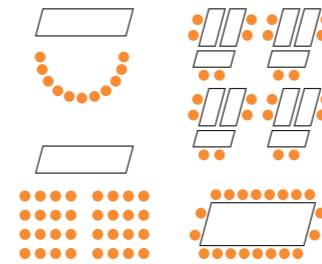

Features /

Wireless internet
 Laptop
 Interactive dual-touch screen plus integrated speakers
 Wireless pointer
 Flipchart stand and pens

Benefits at-a-glance /

- ▶ Natural daylight
- ▶ Flexible room layout
- ▶ Projector and portable screen
- ▶ Brilliant acoustics
- ▶ Comfortable seating

Convert the space /

Earlsfield is a light, flexible self-contained space. This room is a smart solution for business training and meetings.



Santino Fragola

SMART PEOPLE /
Santino Fragola

Head of Lifelong Learning
 Wandsworth Borough Council

Why WPDC?

Wandsworth takes lifelong learning seriously, which is why every year more than 10,000 people benefit from courses. "This building works brilliantly as a training and learning environment. It is award winning, has amazing views and is a calm space for thinking and reflecting. Learners feel safe, relaxed and comfortable here because this is a welcoming business-like environment with outstanding customer service," says Santino who is a long-term Tooting resident. "Living in the borough gives you a bit of an edge because you understand it like a local and experience all the services," he says.

What was it like?

Santino, who knows the power of location, likes to book courses for this centre not just because it is well-sited or close to uber-cool Tooting, but because, "it's such a brilliant space and you've got everything you need to concentrate on the reason you're here."

Book Earlsfield /



Contact our dedicated team of event experts today, for availability, rates and viewing appointments.

Bookings and enquiries:
 e / wpdc@wandsworth.gov.uk
 t / 020 8871 8775



Wandsworth Professional Development Centre (WPDC)

3rd Floor, Building 1
Burntwood School
Burntwood Lane
SW17 0AQ

Bookings and enquiries:
e / wpdc@wandsworth.gov.uk
t / 020 8871 8775

SMART CHOICE /

Smart space for smart thinking people

Industry-leading facilities /

Whatever your event, whether a conference, meeting, training session or something completely out of the ordinary, WPDC has a range of rooms to suit your needs. Whether you book a single, or a combination of rooms.

Why not work with our team to fully utilise the various spaces available – by opening up adjoining rooms via our folding walls perhaps or creating bespoke break out areas.

Fantastically located just a short stroll from Earlsfield Station, our bright and modern venue has everything you need to deliver a professional and impressive event.

Benefits at-a-glance /

- ▶ Dedicated, friendly team
- ▶ Full on-site catering facilities
- ▶ Excellent transport links with some on-site parking
- ▶ AV and IT facilities
- ▶ Fully accessible to wheelchair users
- ▶ Cost-effective pricing structures

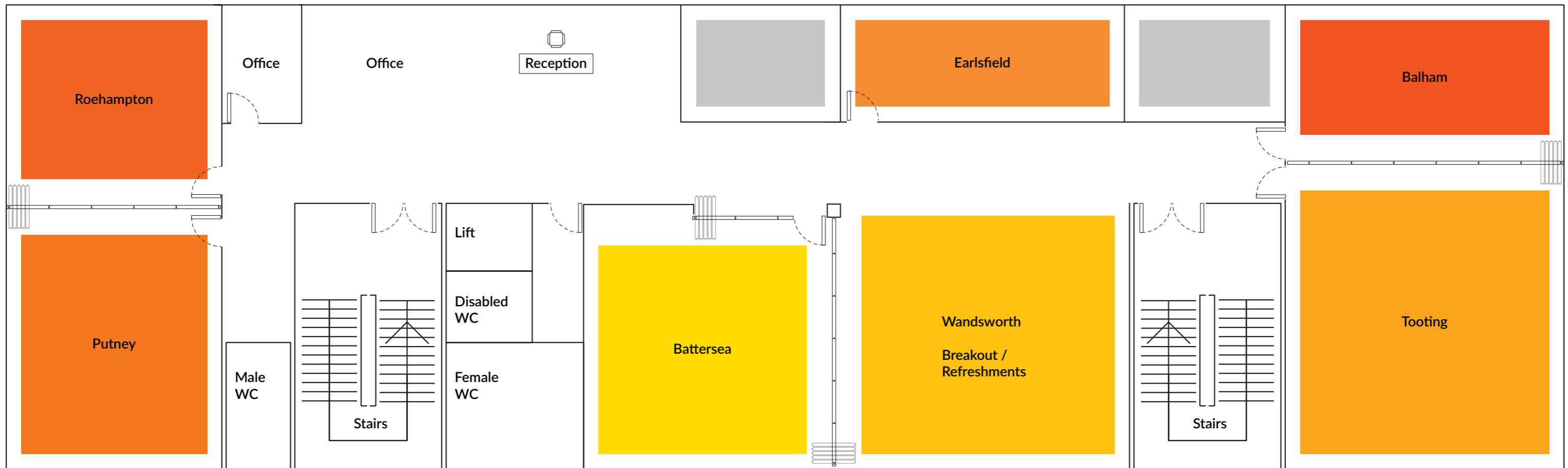



SMART PEOPLE / Melanie Ashdown

Health Care Manager
Integrated Care Support Services

First impressions count, and they certainly proved worthwhile for Melanie Ashdown when she dropped into the Wandsworth Professional Development Centre. "I asked whether I could have a tour and the Operations Manager was very welcoming, showing me round and I thought 'wow, this is really nice. It's in central Wandsworth, right in the middle of the borough and having a car park is a big bonus!'"

Training is a key part of healthcare. Melanie's role is to support education opportunities for primary care staff, which includes nurses, receptionists and GPs. Some staff need annual updates or additional training to help GP practices run more smoothly. But there is an art to organising effective training and that includes picking the right space. "When you take staff out for training ideally you would like a good space that is welcoming, professional and cost effective."

Melanie explains that WPDC being part of Wandsworth Council was another positive factor for her team. "Integrated Care Support Services is a not-for-profit company so it's appealing that the money is invested in the community. Part of training is helping staff feel valued. You want staff to feel good about their career development. If you bring staff here it's a real day out that's worth paying for," she adds.

Arrange Your Visit /

Contact our dedicated team of event experts today, for availability, rates and viewing appointments.

Bookings and enquiries:
e / wpdc@wandsworth.gov.uk
t / 020 8871 8775

"Part of training is helping staff feel valued. You want staff to feel good about their career development. If you bring staff here it's a real day out that's worth paying for."





“It’s smart, modern and slick.”
 Ali Epton





Wandsworth Professional Development Centre (WPDC)

3rd Floor, Building 1
Burntwood School
Burntwood Lane
SW17 0AQ

Bookings and enquiries:
e / wpdc@wandsworth.gov.uk
t / 020 8871 8775

