

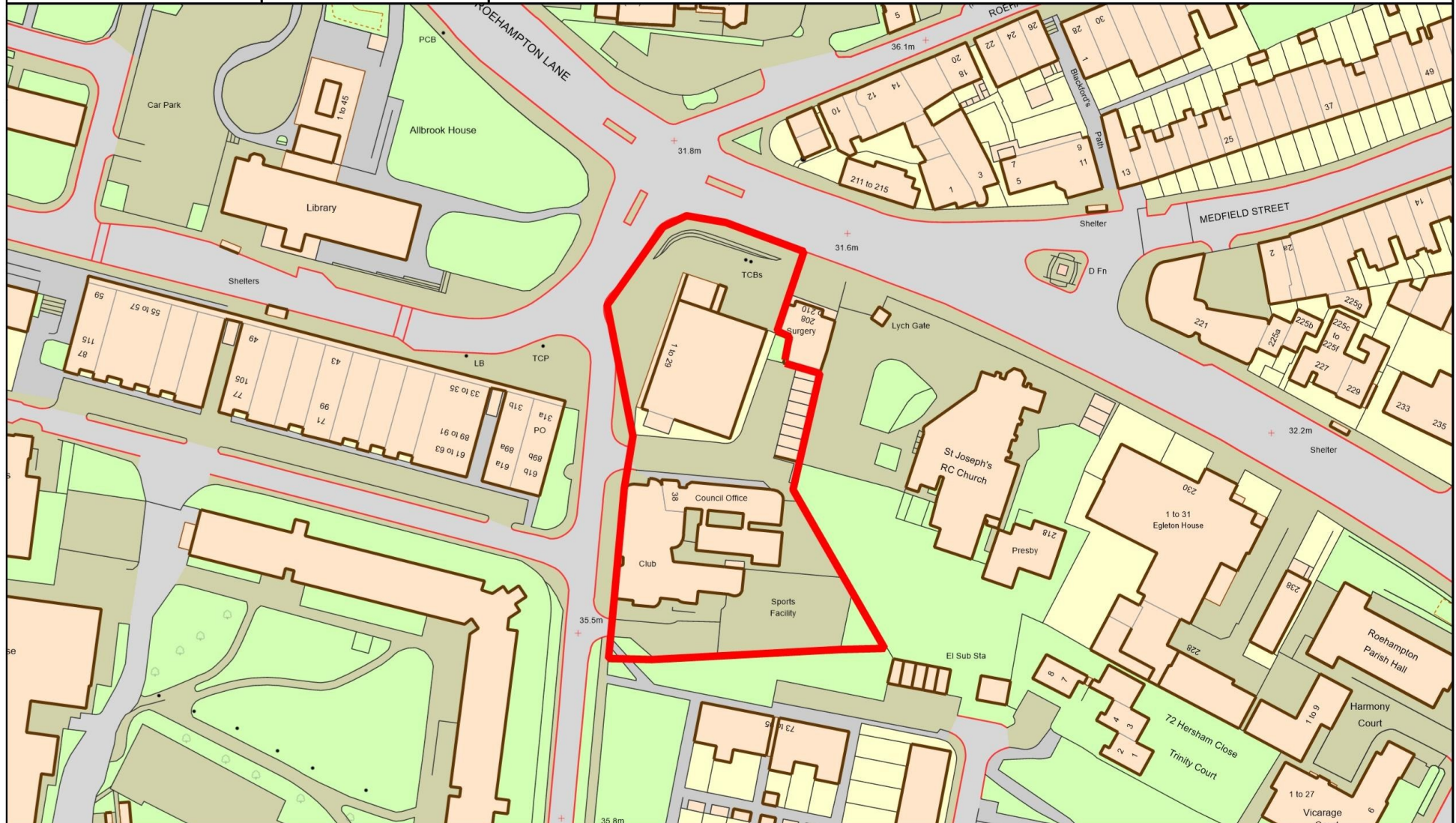

1:1250

Community/ Residential 'Block A' - Location Plan



Reproduced from the Ordnance Survey mapping with the permission of the Controller of Her Majesty's Stationery Office ©Crown copyright.
Unauthorised reproduction infringes ©Crown copyright and may lead to prosecution or civil proceedings.
Wandsworth Borough Council Licence No. LA 100019270 (2022)



1:1250

Alton Activity Centre - Location Plan



Reproduced from the Ordnance Survey mapping with the permission of the Controller of Her Majesty's Stationery Office ©Crown copyright. Unauthorised reproduction infringes ©Crown copyright and may lead to prosecution or civil proceedings. Wandsworth Borough Council Licence No. LA 100019270 (2022)

2 Landscape Design Update Play Strategy (Local and Youth Play) Alton Activity Centre

Alton Activity Centre is the youthful heartbeat at the centre of the Alton Estate. It is situated between Downshire Field and the Village Square. The newly designed workspace will attract people from the estate and across the Roehampton area to engage in a diverse and dynamic range of active experiences.

The existing play space is of poor quality and does not meet the requirements expected of a modern play environment and as set out in SPD Shaping Neighbourhoods: Play and Informal Recreation September, 2012. High fences currently impede community interaction with the play space. The existing building facility maintains it's current use. The future management of this facility is to be considered separately from the landscape proposals of this application.

The new Alton Activity space has been completely redesigned with the exception of the Activity Centre building which is retained. Civic in nature, the Alton Activity Centre will be purposefully bold and visually rich with ambient floor graphics to create an identity that is striking and unique to the Roehampton area, complementing existing local playing fields and play facilities.

The unique site topography is utilised through a series of dramatic soft terraces, ledges and undulating landform which snake across the site, providing opportunities to sit, climb, scramble and explore.

Soft landscape is used to frame play zones with varied textures, colours and heights. Lush perimeter planting and fencing provides safety and security. Existing trees are retained where possible to add a sense of maturity to the new play space. New trees will provide shade and shelter as well as bold seasonal colour. Social corners to relax and watch others while adjacent physical play are notched into planting.

The hierarchy of play space has been defined by the age groups of children who will come to use it. Ages of 0-5, 0-11 & 12+ are provided zones in which to play, ensuring there is not a clash between age group activities.

Elements of sensory, balancing, climbing, sliding and spinning are playfully weaved throughout the Activity Centre play space. A half MUGA court provides informal and programmed sport, recreation activity, skating and a stage for performance.

A play trail dots across the play space, up and over mounding and through planting as an adventurous way for children to navigate and provide moments of discovery and joy. An area of grow garden is included adjacent the Activity Centre to promote health and well-being and engage youth in food production.

The play space will include low level bollard lighting along paths and pole mounted lighting surrounding the MUGA court. All lighting will have automatic and manual control to ensure surrounding residents are not adversely impacted.



- Legend**
1. Youth 12+ zone, includes 1/2 MUGA, skateable elements, screening and painted supergraphics.
 2. Pocket lawn seating spaces.
 3. Perimeter tree and planting with fencing. Existing trees retained.
 4. 0-11 play zone, includes undulating rubber surfacing, balancing and climbing equipment.
 5. Gated entry points.
 6. New structure to provide shelter from the weather.
 7. Art area - boards for painting.
 8. Play trail.
 9. Vibrant tree and planting with seasonal character.
 10. 0-5 play zone. Fenced area includes balancing and jumping equipment.
 11. Grow garden.
 12. 0-11 play zone, includes play terraces for climbing and sensory equipment.
 13. Additional storage area.
 14. Steps and accessible ramp route.
 15. Linear bench & Terraces, used for seating, play and retaining existing topography.



2 Landscape Design Update

Play Strategy (Local and Youth Play)

Alton Activity Centre - Site Sections



Legend

- 1 1.2m perimeter fence in planting
- 2 Social seating area
- 3 1/2 MUGA court with screening
- 4 Skate-able wall with play features integrated within.
- 5 Undulating play surface with extruded rubber forms
- 6 Net climbing and balancing equipment
- 7 Sensory play equipment
- 8 Pergola / Shade Canopy
- 9 Activity Centre Building - no change

Left: Play hub section looking north

Below: Play hub section looking east towards Block K

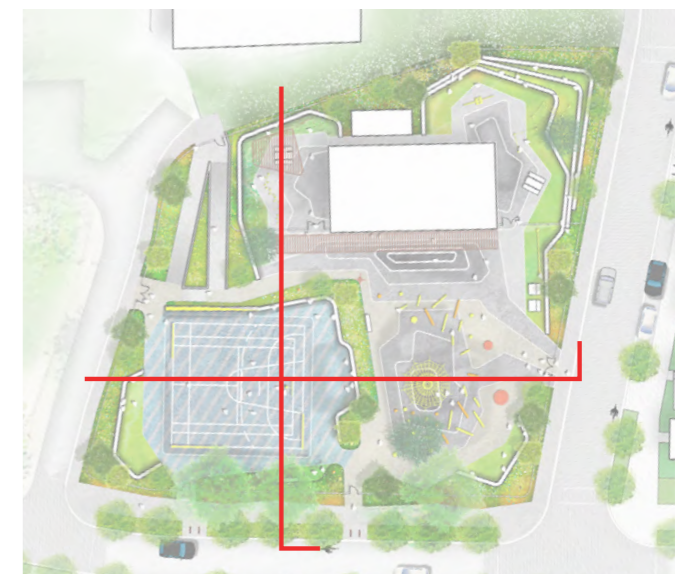

2 Landscape Design Update

Play Strategy (Local and Youth Play)

Alton Activity Centre - Materials and Equipment Palette



Location Key Plan

SURFACES



Rubber safety surface
Type: Rubber, 2 tones



MUGA surface
Type: Coloured asphalt surfacing
Colour: Supergraphics paint



Resin bound paths & Lawn
Type: Resin Bound Natural Aggregate 6mm & Reinforced turf

PLAY



Sculptural balancing equipment.
Type: See-saw, posts and climbable configurations



Play trail
Type: includes sculpture play elements, balancing equipment and art boards

PLAY cont.



Sensory Play
Type: Sounds, smell, sight and taste - inclusive play



Undulating landform
Type: Rubber safety surface



Climbing Equipment
Type: Space net, climbing walls, landscape terraces,



1/2 MUGA & skate-able zone
Type: Court for multi games, includes screening to enclose ball games. Benches, 1/4 bowl, undulated surface create skating opportunities



Multi purpose linear elements
Type: Concrete seat/terrace/play element. Varied height to allow for incidental play

FURNITURE



Perimeter fence and gate
Type: 1.2m metal fence & gate - vertical rails/slats



Lounge Seat
Type: 'Bloc sun bench' lounge seat by Vestre - yellow

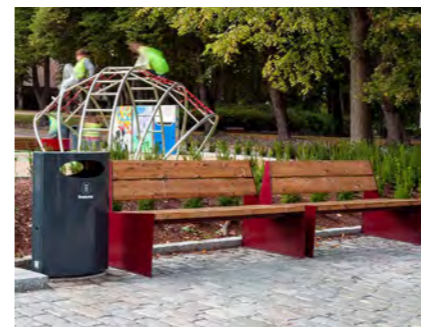

Long Bench
'Bloc' bench by Vestre - Yellow



Rubbish Bin
Play Hub - 'Bloc' bin (yellow) by Vestre



Table with bench seating
'Vroom' table and bench by Vestre

Legend

1. Youth 12+ zone, includes 1/2 MUGA, skateable elements, screening and painted supergraphics.
2. 0-11 play zone, includes undulating rubber surfacing, balancing and climbing equipment.
3. Gated entry point, including planting with fencing.
4. New structure to provide shelter from the weather attached to Alton Activity Centre.
5. Art area - boards for painting.
6. Vibrant tree and planting with seasonal character.
7. 0-5 play zone. Fenced area includes balancing and jumping equipment. Grow garden.
8. 0-11 play zone, includes play terraces for climbing and sensory equipment.
9. Linear bench & Terraces, used for seating, play and retaining existing topography.

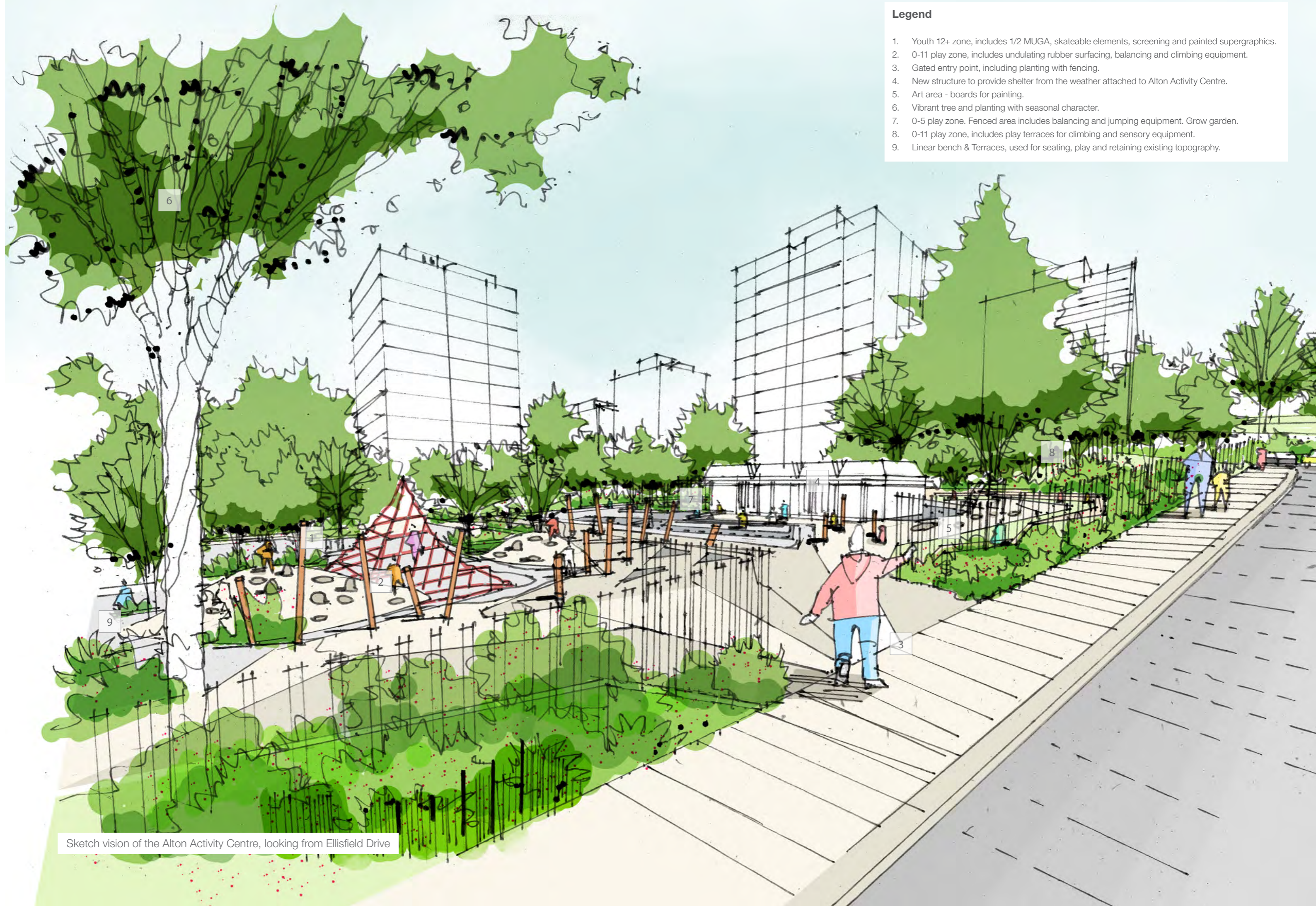

Sketch vision of the Alton Activity Centre, looking from Ellisfield Drive



1:2048

Downshire Field - Location Plan

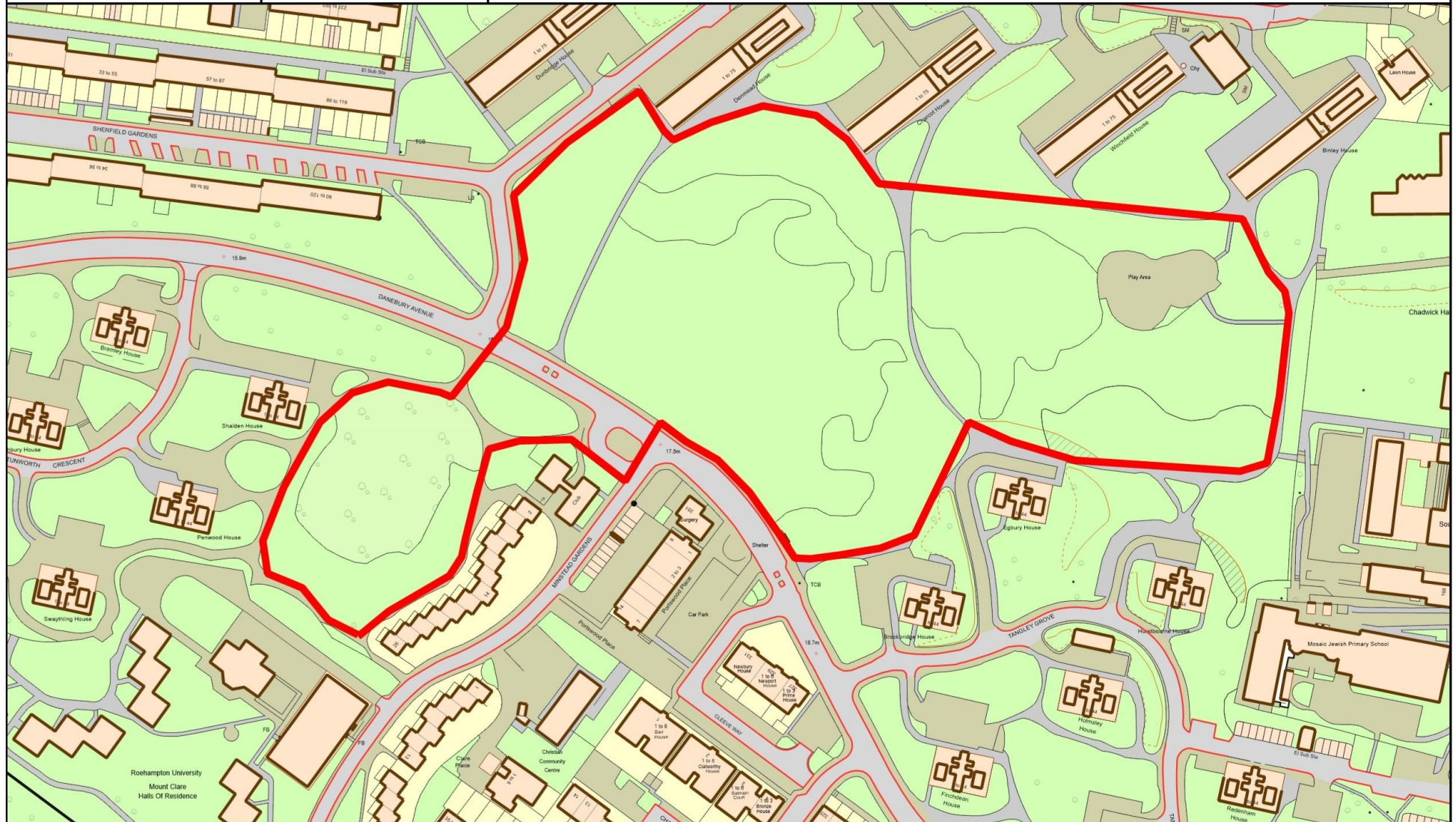

Reproduced from the Ordnance Survey mapping with the permission of the Controller of Her Majesty's Stationery Office ©Crown copyright. Unauthorised reproduction infringes ©Crown copyright and may lead to prosecution or civil proceedings. Wandsworth Borough Council Licence No. LA 100019270 (2022)

2 Landscape Design Update Play Strategy Downshire Field

The Parkland Quarter is an incredible asset for Alton Green. Previous feasibility proposals included intensive landscape works, but it was decided through consultation with residents this was not appropriate, instead a sensitive and enhancement works is proposed. The field is a fantastic opportunity for formal and informal play and recreation. The following are some of the key design features:

1. Resin bound loop path network for cyclists and pedestrians. Includes distance markers.
2. Existing tree network retained. Sensitive tree removal only where required. Below the trees includes a carpet of shade tolerant meadow below.
3. Timber trim trail dotted beneath the tree canopy along 1km path network. Timber trim trail equipment will be sensitively designed and located in relation to the landscape setting and views of the conservation area and listed buildings.
4. Open cut Downshire Field lawn. Used for events, and general residents and community use.
5. Rain garden planting at road edge. Footpath runs between planting and lawn.
6. Existing tree cluster - minor thinning of trees to allow for safe circulation.
7. Wild-flower meadow. Pocket greens that respond to Highcliffe Drive. Includes cut lawn area with picnic tables.
8. New paths connect blocks to Downshire Field loop path. Resin bound paving.
9. Downshire Field Play Space. Naturalistic play, 0-11+ years old. Perimeter planting and meadow with fencing around play space.
10. Mount Clare existing trees - minimal intervention. New resin bound path network continues across from Downshire Field.
11. Wild-flower meadow with picnic seating opportunities and timber trim trail stations.

Timber Trim Trail Stations (refer to palette on following page for equipment look and feel):

- a. Thermoplastic line markings to denote distance on the footpath.
- b. Leapfrogging fitness station
- c. Gate climbing
- d. Parallel Bar
- e. Ab bench
- f. Arm stretch
- g. Triple balance beam



2 Landscape Design Update

Play Strategy

Downshire Field - Trim trail and Incidental Play Palette



Location Key Plan

PLAY



Incidental Play
Type: Natural boulders dotted randomly surrounding meadows



Picnic Bench
Product: X-Table picnic table by Streetlife



Trim Trail Element A
Type: Thermoplastic line markings to denote distance on the footpath.



Trim Trail Element B
Type: Leapfrogging fitness station.

PLAY



Trim Trail Element C
Type: Gate climbing



Trim Trail Element D
Type: Parallel Bar



Trim Trail Element E
Type: Ab bench



Trim Trail Element F
Type: Arm stretch



Trim Trail Element G
Type: Triple balance beam

2 Landscape Design Update Play Strategy Downshire Field Play Space (existing local play space - redesigned)

Situated at the top of Downshire Field, the proposed Downshire Field Play Space forms a naturalistic play area responding to its unique location amongst parkland mature trees. At ground level the play space is nestled within wildflower meadow and lush native plant mixes. The planting provides the backdrop for exploration, discovery and endless imaginative play.

This space will be the main play space on Downshire Field. It is a complete redesign of an existing play space of poor quality that is no longer fit for purpose.

A palette of natural materials will create seating, fencing and playable features. The play space will be informal, rather than the civic qualities of Alton Activity Centre. It will primarily use natural surfaces such as lawn, planting, bark, sand and gravel with some neutral toned rubber safety surfacing.

The design features a variety of scaled spaces that cater for different age groups (0-11 years), carefully positioned to create a safe environment for all ages to play freely as well as providing seating for guardians to perch, socialise and watch on.

The play space includes various play elements to test gross and fine motor skills, spatial, balance and climbing practice, social play, changes in level with undulating planted topography and areas to dig and build.

To ensure safe play and security for children, a simple boundary fence set amongst structural planting is incorporated around the perimeter.

Aspects of inclusive play have been considered with wheelchair accessible zones. A range of sensory play activities are included that enable all children to play together, no matter what their ability. Sensory play includes touch, smell, sound and visual stimulation.

The Downshire Field Play Space fits within a wider parkland zone (Downshire Field & Mount Clare). Other amenity features include visible biodiversity enhancement (bird/bat boxes and log piles), a 1km marked running, walking and cycle loop path, wildflower meadows with clearings of cut lawn with picnic tables, retained existing mature trees and a large lawn space for picnics, kick about and community events.

A trim trail with natural exercise stations is included along the 1km path. These are integrated in the landscape using timber elements for sitting, stretching, jumping and exercising.

The play space will not include lighting.



Legend

1. Pocket seating spaces.
2. Perimeter tree and planting with fencing. Existing trees retained.
3. 0-11 play zone, includes wildflower mounded landform, timber balancing, climbing and sliding equipment.
4. Rubber, bark and sand play surfacing.
5. Dried and treated felled tree.
6. Gated entry points.
7. Natural stone and timber play trail.
8. Vibrant tree and planting with seasonal character.
9. 0-5 play zone. Fenced area includes balancing and jumping equipment trail and sand digging.
10. Linear timber bench used for seating, play and retaining existing topography.



2 Landscape Design Update

Play Strategy

Downshire Field Play Space



Legend

- 1 Pocket seating spaces.
- 2 Perimeter tree and planting with fencing. Existing trees retained.
- 3 0-11 play zone, includes wildflower mounded landform, timber balancing, climbing and sliding equipment.
- 4 Rubber, bark and sand play surfacing.
- 5 Dried and treated felled tree.
- 6 Gated entry points.
- 7 Natural stone and timber play trail.
- 8 Vibrant tree and planting with seasonal character.
- 9 0-5 play zone. Fenced area includes balancing and jumping equipment trail and sand digging.
- 10 Linear timber bench used for seating, play and retaining existing topography.



Above: Play hub section looking north

2 Landscape Design Update

Play Strategy

Downshire Field Play Space - Materials and Equipment Palette



Location Key Plan

SURFACES



Play surface
Type: Rubber safety surface, neutral earth tones.



Play Surface
Type: Bark chippings



Play Surface
Type: Sand



Lawn Area
Type: Fibre Reinforced Turf

PLAY



Boulder trail
Type: Natural stone boulders

PLAY cont



Natural log
Type: Dried and treated felled log



Natural exploration trail
Type: Timber trotter trail



Natural tangle equipment
Type: Timberwood tangle with cargo net



Balancing equipment
Type: Timber see-saw



Natural landform with integrated elements
Type: Sensory planting & meadow landform trail

PLAY cont.



Balancing equipment
Type: Timber balancing disc



Natural landform with integrated elements
Type: Reinforced grass mound with small slide.



Digging equipment
Type: Sand digging equipment - including wheelchair accessible.



Sensory equipment
Type: Periscope

FURNITURE



Linear seating
Type: Concrete/Timber seat and play element. Varied height to allow for incidental play

Legend

1. New improved resin bound loop path network.
2. Gated entry.
3. Buffer planting with 1.2m high fence surrounding the play space.
4. Mounded landform.
5. Naturalistic play hub - timber and stone play elements.
6. New shade and sun tolerant wild-flower meadow.
7. Downshire Field.

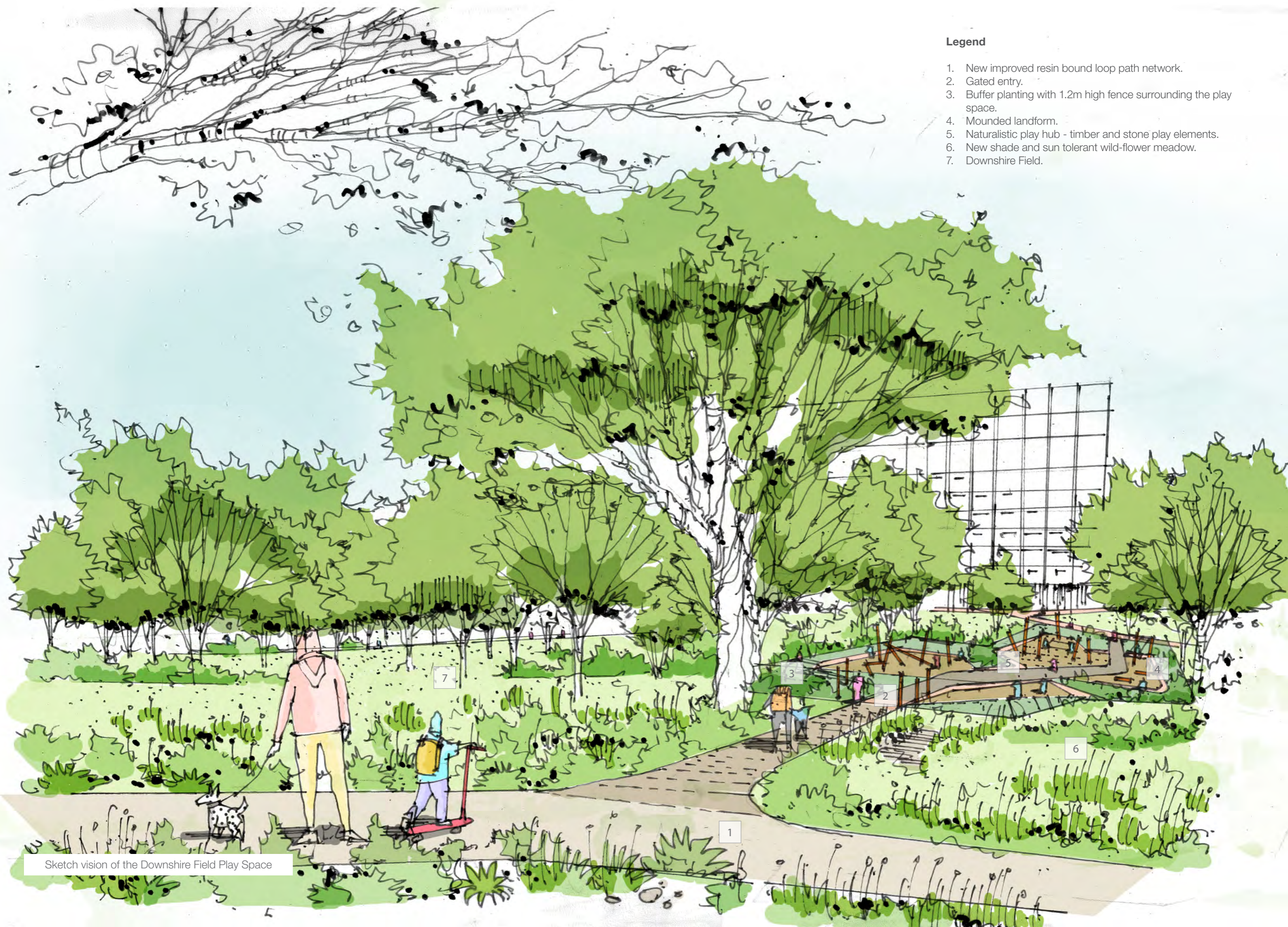

Sketch vision of the Downshire Field Play Space