

**ARTICLE 12 OF THE MINISTRY OF HOUSING AND LOCAL GOVERNMENT PROVISIONAL ORDER  
CONFIRMATION (GREATER LONDON PARKS AND OPEN SPACES) ACT 1967**

**LAND AT TOOTING TRIANGLE, TOOTING COMMON, LONDON.**

**APPLCATION MADE BY THE LONDON BOROUGH OF WANDSWORTH**

**NOTE TO THE INQUIRY CONCERNING SITE NOTICES ERECTED ON TOOTING BEC COMMON GIVING  
NOTICE OF THE ART. 12 APPLICATION AND LOCAL ENGAGEMENT PRIOR TO THE SUBMISSION OF  
ART.12 APPLICATION.**

This note has been produced by Simon Cooper-Grundy.

On day one of the inquiry, an Objector to the application asked for clarification of the site notices erected by the Council in respect of the Art.12 application.

Photographs 1 to 4 show the site notices which were initially erected concerning the Council's art.12 application to carry out works on Tooting Bec Common. These notices were erected on 12<sup>th</sup> November 2020 at the four points shown on the plan attached to the note on consultation (CD 34). These were A3 notices. It came to my attention that one of these initial site notices had been erected the wrong way around (see photograph 2 ). This was corrected on 13 November 2020.

In order to provide additional information about the proposed works, these initial notices were replaced about one week after the erection of the initial notices, with the notices shown as photograph 5 below. These replacement A3 notices were erected in the same places as the initial notices. I do not have photographs of these replacement notices in situ.

Local engagement prior to the submission of the Art.12 application was also raised. Having reviewed my records, I can confirm that a meeting took place on 15<sup>th</sup> July 2020, at Balham Boxing Club, attended by representatives from; the Friends of Tooting Common, Tooting Common MAC, TFC Leisure Ltd, Balham Boxing Club, Enable and Wandsworth Council.

Simon Cooper-Grundy

9 June 2022.



Photo 1





Photo 2





Photo 3





Photo 4





**WANDSWORTH BOROUGH COUNCIL  
TOOTING BEC COMMON BOROUGH OF WANDSWORTH LONDON**

Ministry of Housing and Local Government Provisional Order Confirmation  
(Greater London Parks and Open Spaces) Act 1967, Article 12

**NOTICE IS HEREBY GIVEN** that the Council of the London Borough of Wandsworth is applying to the Secretary of State for Environment, Food and Rural Affairs for consent under article 12 of the Greater London Parks and Open Spaces Order 1967 to carry out restricted works on Tooting Bec Common. The Planning Inspectorate will decide the application on behalf of the Secretary of State. The proposed works are to improve the former Youth Club and Triangle One O'Clock centre buildings by the construction of rear and side extension to the former Youth Club, currently occupied by the Balham Amateur Boxing Club, the installation of new roofing across the former Youth Club and extensions, and the corridor linking this with the former One O'Clock centre building, and the installation of new external doors and disabled access ramps together with the installation of new, artificial grass surfaced all weather sports pitches with associated fencing and floodlights on the adjacent area currently laid out as a redgra surfaced sports pitch.

The improved buildings will provide facilities for the Balham Amateur Boxing Club, with changing and toilet facilities for users of the indoor and outdoor sports facilities tog.omon. They will also provide facilities for the continued provision of stay and play providing year round opportunities for children from the age of 18 months for both indoor and outdoor play and offering parents the choice to join organised activities or play with their children themselves. In total the facilities occupy an area of 5000 sqm. Situated in the north west corner of the Triangle field

The external walls of the metal clad building and the associated extension will be finished in dark green (similar to the current finish) and brick built extension will be painted to match the existing structure. The proposed extension to the buildings increases the built footprint from current 399 sq.m. to 456 sqm, an increase of 57 sqm. (+ 14.3% approx.)

There is no increase in the area occupied by the outdoor sports pitches.

A temporary compound for the storage of construction materials will be located on the hard surfaced area to the west of, and opposite the development site.

Due to Government advice in respect of Coronavirus (COVID-19), a copy of the application will not be left in a public area for viewing. However, a copy of the application form and accompanying documents may be obtained by writing to either:

Joanna Shearer  
Leisure and Culture Contract Manager  
Environment and Community Services  
Tadmire House, Unit 1F  
Wandsworth  
SW18 2PU  
Email: [Joanna.shearer@richmondandwandsworth.gov.uk](mailto:Joanna.shearer@richmondandwandsworth.gov.uk)  
Telephone: 020 8871 6377

or  
Simon Cooper-Grundy  
Enable Leisure and Culture  
The Parks Office  
Battersea Park  
London  
SW11 4NJ

Email: [scooper-grundy@enable.co.uk](mailto:scooper-grundy@enable.co.uk)  
Telephone: 07802 313822A copy of the application form and accompanying documents can be viewed at:  
[wandsworth.gov.uk/tooting-common-application](http://wandsworth.gov.uk/tooting-common-application)

The application form and accompanying documents will be available until Monday 14th December 2020.

In view of the pandemic, any representations should, where possible, be sent only by email ON or BEFORE that date to: [commonlandcasework@planninginspectorate.gov.uk](mailto:commonlandcasework@planninginspectorate.gov.uk)

Representations sent to the Planning Inspectorate cannot be treated as confidential. They will be copied to the applicant and possibly to other interested parties. For information about how the Planning Inspectorate processes personal information please see the Common Land Privacy Policy at <https://www.gov.uk/government/publications/common-land-guidance-sheet-13-privacy-policy>

PAUL MARTIN  
Chief Executive and Director of Administration  
The Town Hall  
Wandsworth High Street  
London  
SW18 2PU

DATED this 12th day of November 2020

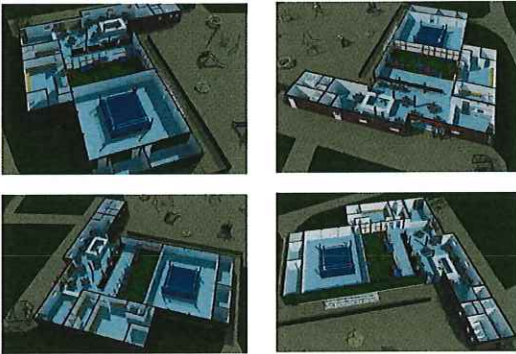

CUT AWAY CGI VIEWS OF THE NEW FACILITIES

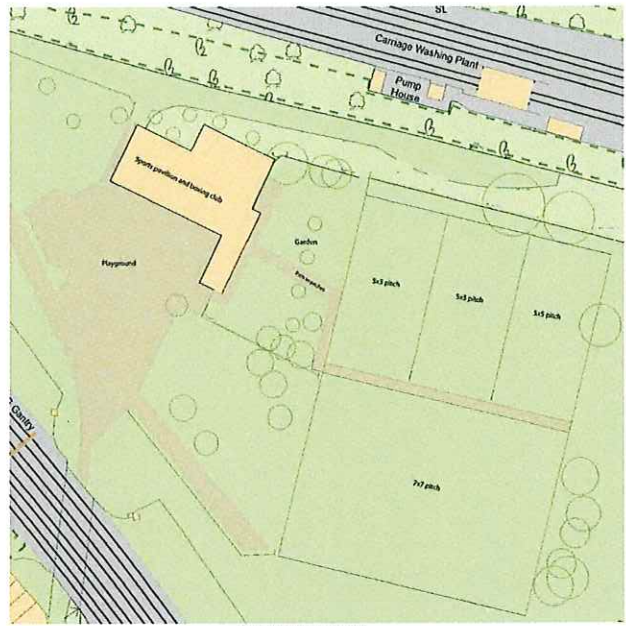

PLAN OF THE NEW FACILITIES



SATELLITE VIEW OF THE EXISTING SITE



CGI OF THE REFRUBISHED CLUB HOUSE BUILDING

**Rocks Lane in the community**

Rocks Lane have been chosen to develop and manage the community sports facilities at Tooting Triangle.

With over 30 years of experience, open access to sport is central to our philosophy at Rocks Lane.

Open access to sport is central to our philosophy at Rocks Lane. We link with local schools, local authorities, national governing bodies, local charities, football clubs, sporting foundations and grant aiding bodies to achieve this goal.

Rocks Lane Sports Trust seeks funding to provide sporting opportunities for all. Initiatives have included projects for children and adults with learning challenges, wheelchair tennis, tennis for the deaf, adults with mental health challenges, borough-wide school sports initiatives, scholarship schemes for talented youngsters and female-focused schemes in football, tennis and netball.

**Play, learn and compete**

The three essential ingredients:

**Play:** Turn up with your mates, have a kick around, swing a racket, shoot a hoop, tumble around on our soft play areas, swing and slide in our playground.

**Learn:** Children start from the age of one in our mini multi-sport sessions, following Early Years Learning principles, coupled with Montessori-style teaching. Giving children the opportunity to develop agility, balance and coordination is an essential foundation for them to enjoy sport for the rest of their lives at Rocks Lane.

**Compete:** We offer numerous opportunities for all children to enjoy competition.



CGI VIEW OF THE NEW SPORTS PITCHES



EXISTING SPORTS PITCH